

RADIATOR VALVE INSTALLATION

Bleeder



Plug



Optional
Thermostatic Head



R470

R431 Right angled
manual valve

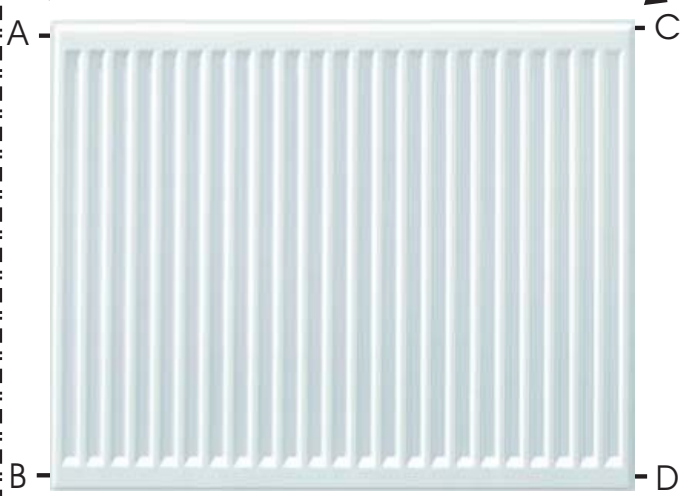

R29 Right angle
Lock shield valve



R179 Multi layer pipe fitting



R178 Copper adaptor



"O" RING



T BRASS SECTION



"O" RING



TAPERED OLIVE
(NOTE: TAPPER TOWARDS NUT)

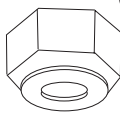

16MM NUT

R178 Copper adaptor



R179 Multi layer pipe fitting



R175A Plastic cover

FLOW

R178 COPPER CONNECTOR, TIGHTEN
UNTIL OLIVE FIRMLY EMBEDS INTO COPPER

R175A Plastic cover

RETURN

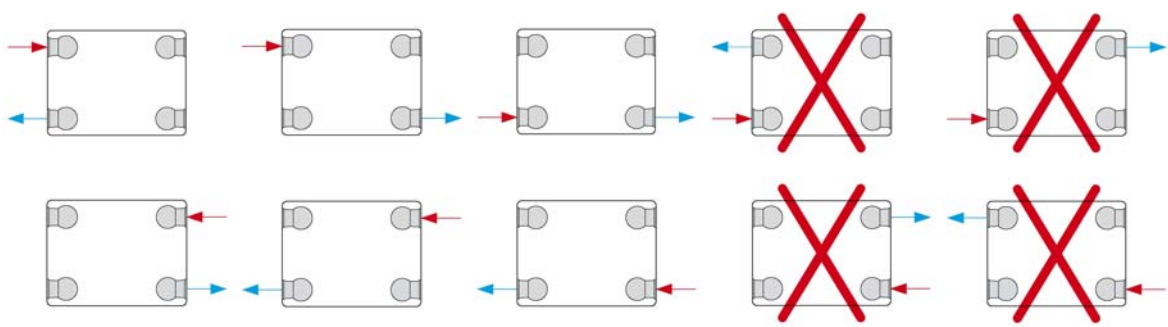

Please use plumbing paste such as "LOXEAL" on all radiator fittings. Including Plug and bleeder



HYDROHEAT SUPPLIES PTY LTD
P.O. BOX 1045 / 6 Helen Kob Drive
Braeside, Victoria, 3195
Ph 03 9588 1299 Fax 03 9588 2199

Drawn: Ivan Karaula
Update: Sept. 2016

Recommended Radiator valve installation for nursing homes

Bleeder



Plug



R415 Reverse angle valve body
R470 Thermostatic head



R29 Right angle Lock shield valve

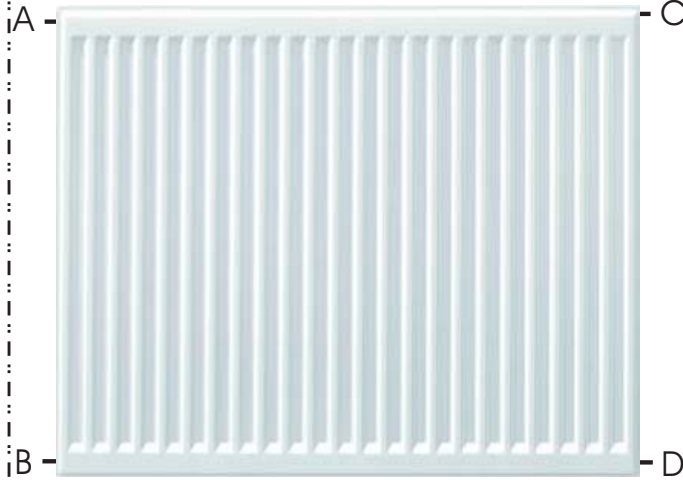

R179 Multi layer pipe fitting

R178 Copper adaptor

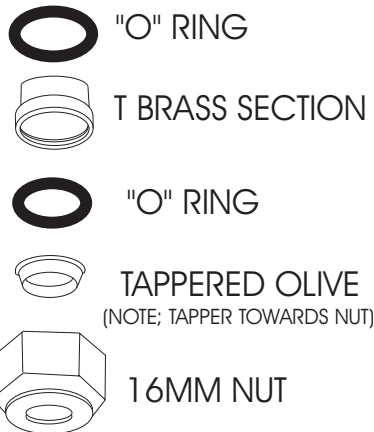

R178 Copper adaptor

R179 Multi layer pipe fitting

R175A Plastic cover

FLOW

R178 COPPER CONNECTOR, TIGHTEN UNTIL OLIVE FIRMLY EMBEDS INTO COPPER

R175A Plastic cover

RETURN

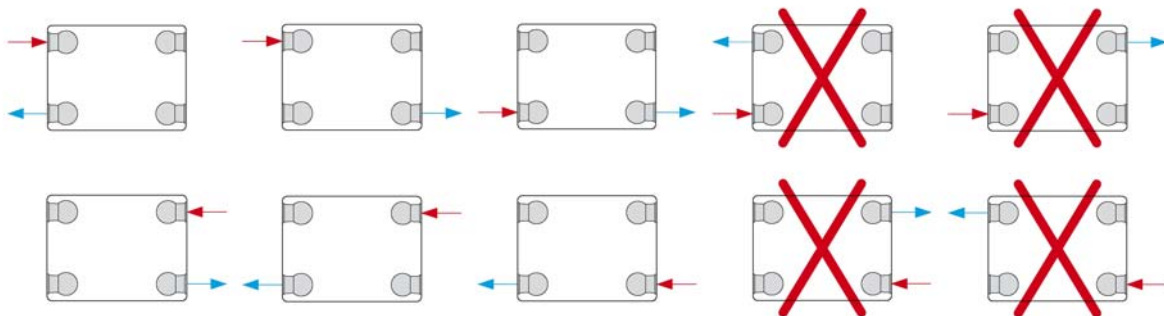

Please use plumbing paste such as "LOXEAL" on all radiator fittings. Including Plug and bleeder

Drawn: Ivan Karaula
Update: June 2017



HYDROHEAT SUPPLIES PTY LTD
P.O. BOX 1045 / 6 Helen Kob Drive
Braeside, Victoria, 3195
Ph 03 9588 1299 Fax 03 9588 2199